

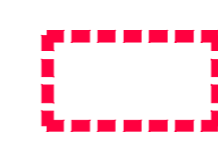
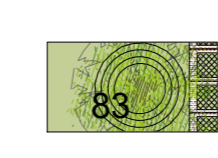
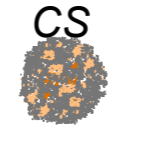
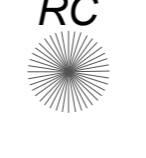

LEGENDA

 Ambito di intervento: St mq 34.875,51 (ai fini del calcolo degli indici)

 Specie arbustive da mantenere (con riferimento all'elaborato A.06)

DESCRIZIONE ESSENZE ARBOREE E ARBUSTIVE IN PROGETTO

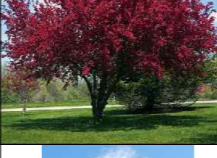
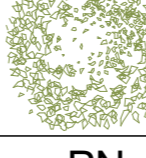
SIMBOLO	MATERIALE VEGETALE	FOTO
	CORNUS MAS - Corniolo	
	VIBURNUM OPULUS - Viburno	
	CORNUS SABGUINEA - Sanguinello	
	ROSA CANINA - Rosa selvatica	
	PRUNUS SERRULATA - Ciliegio da fiore Parcheggio	
	CYTISUS SCOPARIUS - Ginestra	
	BERBERIS VULGARIS - Crespino	
	LIGUSTRUM VULGARE - Ligustro	
	MALUS PROFUSION - Melo da fiore	
	CARPINUS BETULUS - Carpino bianco	
	POPULUS ITALICA NEGRA - Ploppo italiano	
	ACERO CAMPESTRE	

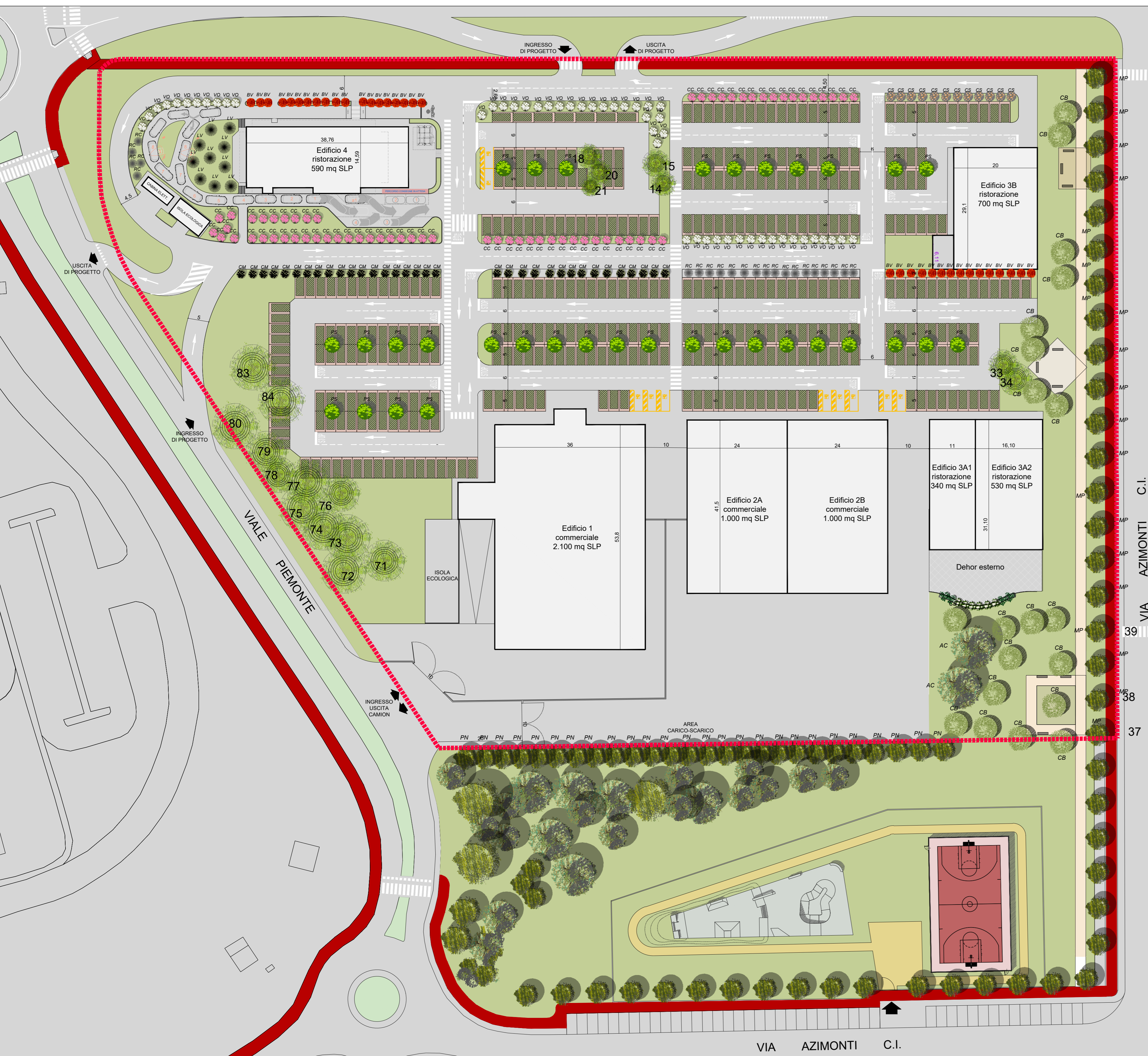

IMMOBILIARE SAN PATRIZIO S.R.L.
Corso G. Matteotti , 49 - 10121 Torino (TO)

COMUNE DI
CASTELLANZA (VA)

Piano Attuativo
Ambito di Trasformazione
AT 3A
"Ex mostra del tessile"

Titolo elaborato : Planimetria di progetto opere a verde di riqualificazione
All.to n. B_02

Revisori	Controllato	Approvato	Data : Luglio 2021	Agg.to : Dicembre 2021	Scala : 1: 500
----------	-------------	-----------	--------------------	------------------------	----------------

Concept Design : _____

Consulenze : _____

Il Progettista :  architecture design and development srl
via Boccia 12 10121 Torino (TO) tel. +39 011 4819622 fax +39 011 4819628
 via Boccia 12 10121 Torino (TO) tel. +39 011 4819622 fax +39 011 4819628

Visto _____